



**Storage Cabinets**

**Storage Shelves**

**Storage Racks**

**Casework**

# STORAGE

**Unique Stainless Steel Solutions**



All Palbam Class cleanroom cabinets have been specially designed to be either shipped flat packed and assembled by customer or shipped assembled. The choice is yours.

Assembly Instructions are included with all cabinets. Assembly is quick and easy requiring no special tools or expertise.

Fabrication materials: stainless steel 304 with electropolished finish.

**FULL LENGTH CABINETS**



This specially designed cleanroom cabinet is shipped flat packed and assembled easily by the customer. This protects the cabinet during transport and reduces shipping costs. "In stock for immediate shipping".

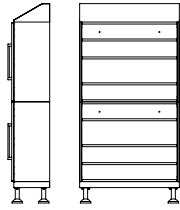

Product	LxWxH (mm)	LxWxH ( " )	Cat. No.
Full length Cabinet 4 doors 6 shelves	1000x380x2000	40x15x79	<b>Q1001</b>
Full length Cabinet 4 doors 6 shelves	1200x450x2000	48x18x79	<b>Q1002</b>

**FULL LENGTH CABINETS - Shipped Assembled**



Cleanroom Full Length Storage Cabinets with 2 swing doors. All shelves are removable. Available with either leveler legs or cleanroom casters. Sloping roof is standard. Fabrication material stainless steel 304 with electropolished finish.

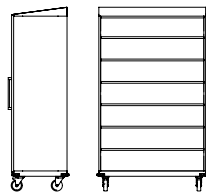

Product	LxWxH (mm)	LxWxH ( " )	Cat. No.
Full length Cabinet 2 doors 6 shelves on leveller legs	1200x600x2100	48x24x83	<b>JF1260</b>
Full length Cabinet 2 doors 6 shelves on casters	1200x600x2100	48x24x83	<b>JF1260C</b>

### FULL LENGTH CABINET



Cleanroom Full Length storage cabinets with 2 swing doors. All shelves are removable. Available with either leveller legs or on casters. Sloping roof is standard. Fabrication material stainless steel 304 with electropolished finish.

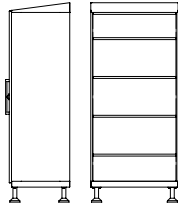

Product	LxWxH (mm)	LxWxH (")	Cat. No.
Full length Cabinet 2 doors 4 shelves on leveller legs	900x600x2100	36x24x83	<b>JF0960</b>
Full length Cabinet 2 doors 4 shelves on casters	900x600x2100	36x24x83	<b>JF0960C</b>

### CLEANERS CABINET



Designed for storing mops and cleaning materials. Fabrication material stainless steel 304 with electropolished finish.

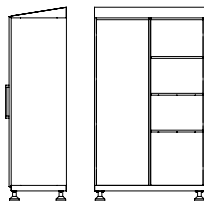

Product	LxWxH (mm)	LxWxH (")	Cat. No.
Cleaners Cabinet on leveller legs	1200x600x2100	48x24x83	<b>JC1260</b>
Cleaners Cabinet on casters	1200x600x2100	48x24x83	<b>JC1260C</b>

**CABINETS WITH GLASS DOORS**



New modern design cleanroom cabinets with safety glass doors allowing easy inspection of contents. Fabrication material stainless steel 304 electropolished finish.

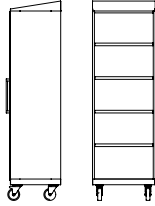

Product	LxWxH (mm)	LxWxH ( " )	Cat. No.
Full Length Cabinet 2 Glass Doors and 4 shelves on leveller legs	660x540x2100	26x21x83	<b>JG0654</b>
Full Length Cabinet 2 Glass Doors and 4 shelves on casters	660x540x2100	26x21x83	<b>JG0654C</b>
Full Length Cabinet 1 Glass Door and 4 shelves on leveller legs	500x540x2100	20x21x83	<b>JG0554</b>
Full Length Cabinet 1 Glass Door and 4 shelves on casters	500x540x2100	20x21x83	<b>JG0554C</b>

**SOILED GARMENT CABINET**



This cabinet is designed to assist in the degowning and collection of soiled garments for washing. The top flap allows for easy disposal and the door has a latch allowing easy emptying by cleaning contractor. Fabrication material stainless steel 304 electropolished finish.

Product	LxWxH (mm)	LxWxH ( " )	Cat. No.
Soiled Garment Cabinet - Flat Top	660x540x1950	26x21x77	<b>GC0608</b>
Soiled Garment Cabinet - Sloping Top	660x540x2150	26x21x85	<b>GC0608S</b>

### 3/4 HEIGHT CABINETS

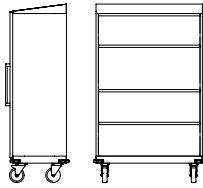

Product	LxWxH (mm)	LxWxH ( " )	Cat. No.
3/4 Height Cabinet on leveller legs	910x483x1500	36x19x59	<b>JEO948</b>
3/4 Height Cabinet on casters	910x483x1500	36x19x59	<b>JEO948C</b>

2 Doors and 3 removable shelves

### 1/2 HEIGHT CABINETS

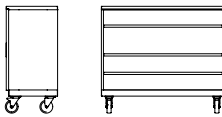

Product	LxWxH (mm)	LxWxH ( " )	Cat. No.
1/2 Height Cabinet on leveller legs	1200x450x1040	48x18x41	<b>JH1243</b>
1/2 Height Cabinet on casters	1200x450x1040	48x18x41	<b>JH1243C</b>

2 Doors and 3 removable shelves

### LOCKER CABINETS

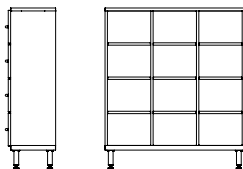

Product	LxWxH (mm)	LxWxH ( " )	Cat. No.
12 Compartment Cabinet on leveller legs	1178x400x1360	46.5x16x54	<b>SC1111</b>
12 Compartment Cabinet on casters	1178x400x1360	46.5x16x54	<b>SC1111C</b>

12 compartments for personal item storage